

Drywall Compression Anchor Detail

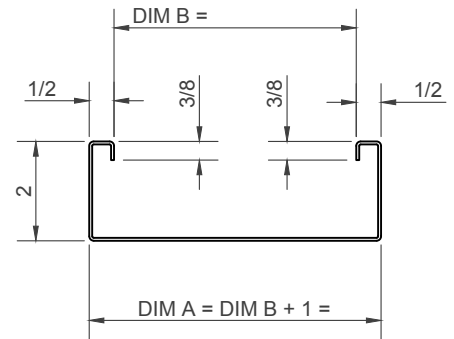

ELEVATION

FRAME SPECIFICATIONS

Finished Opening Size

Finish Opening Width =
 Finish Opening Height =

Rough Opening Size

finish opening width + 2 3/4" =
 finish opening height + 1" =

Frame Size

Wall Thickness "Dim B":
 Frame Width "Dim A":

Frame Material

- 16 Gauge Steel Prime Painted
- 16 Gauge Steel Powder Coated
- 16 Gauge Stainless Steel

Frame Construction

Knock Down Corners

Unit(s) Required:

Door Model #:

Misc Notes:

DOOR SWINGS

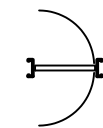

Single
"Left Hand"

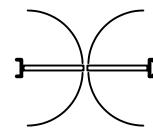

Double

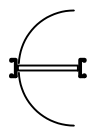

Single
"Right Hand"

Sales Side

MODEL # HOLLOW METAL FRAME – DRYWALL, COMPRESSION ANCHORS – DOUBLE ACTING TRAFFIC DOORS



ELIASON®

PH: 800-828-3655
 FX: 800-828-3577

www.eliasoncorp.com

CUSTOMER INFORMATION:

DATE: 9/12/18

APPROVAL

FORM # SD4686

REV. D